

EZ FRAMES[®]

easy frames by ELSTAR

The image shows a square metal frame with a perforated design. The frame is made of a light-colored metal, possibly aluminum, and has a series of small circular holes along its edges. The frame is mounted on a white background. In the center of the frame, the text "EZ FRAMES" is displayed in a bold, blue, sans-serif font. Below this, the text "easy frames by ELSTAR" is written in a smaller, blue, sans-serif font. A registered trademark symbol (®) is located to the upper right of the word "FRAMES".

EZ FRAMES[®]
easy frames by ELSTAR

EASY FRAMES 55

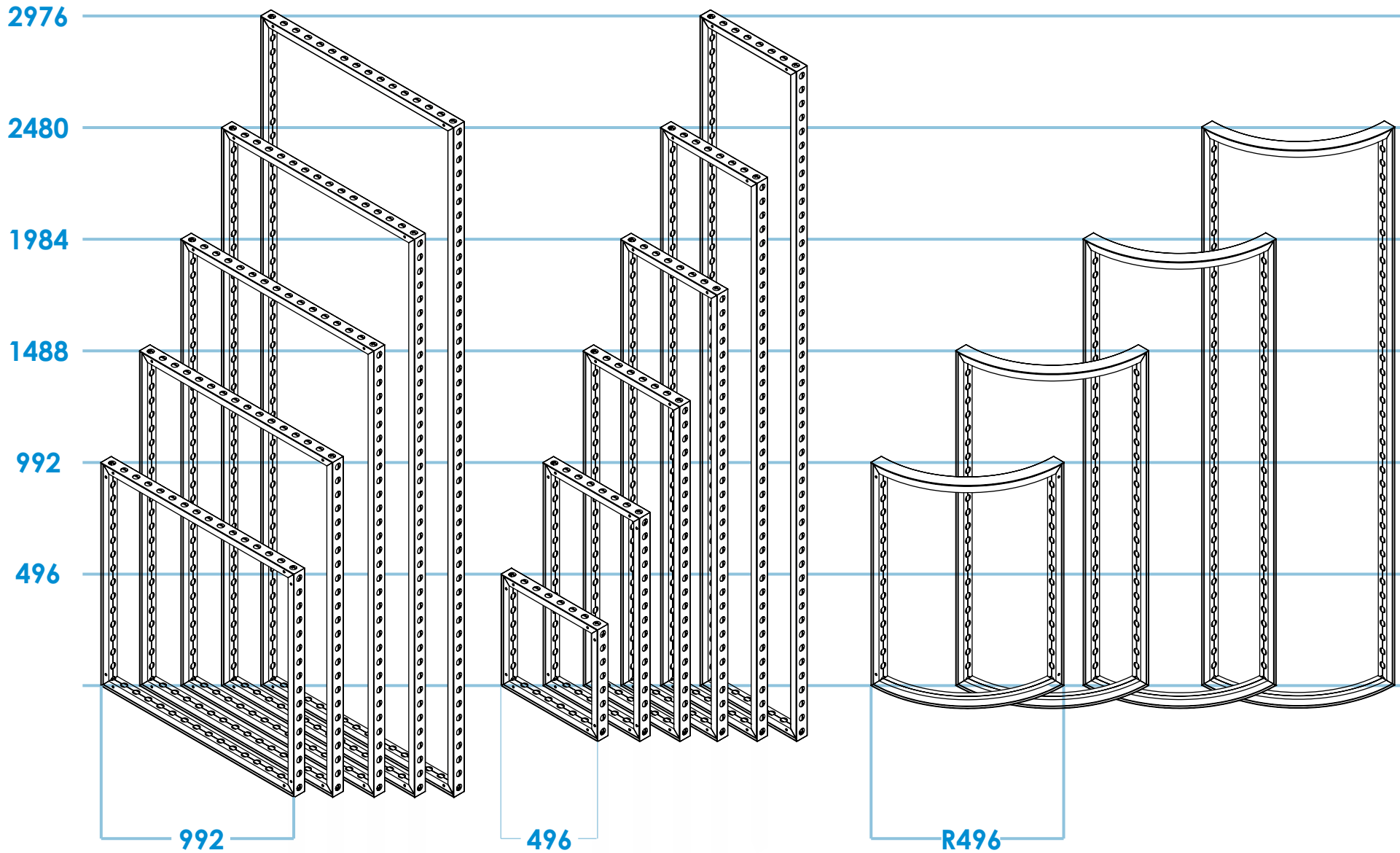

EASY FRAMES 55

The double-sided profiles with holes around created for strong aluminum modular frames especially for the exhibition industry. The frame is only 55 mm thick and matches both fabric and panel (PVC, dibond) on both sides of the profiles. A wide range of accessories for customers' comfort available.

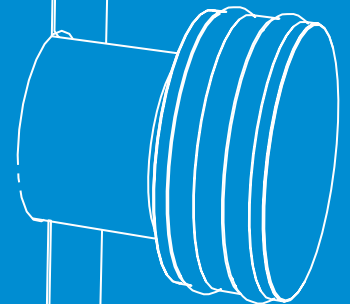

AKCESORIA EZ55

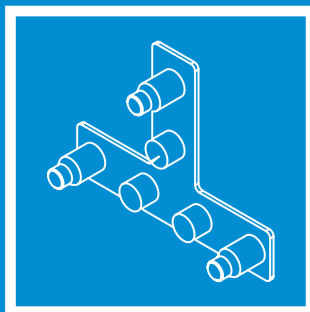

T-plate

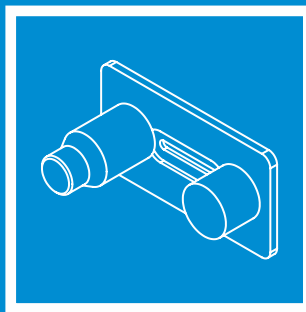

lamp holder

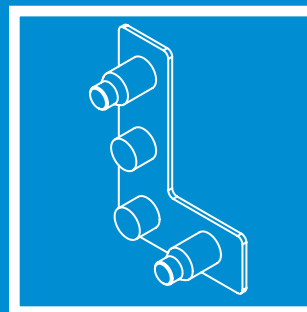

left corner plate

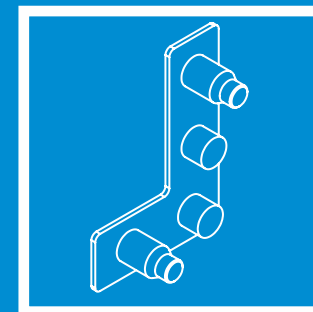

right corner plate

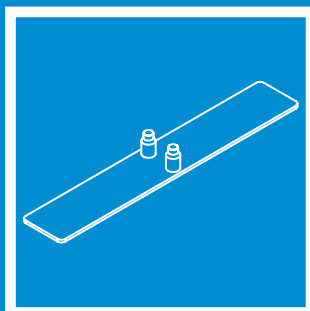

base EF 600x100

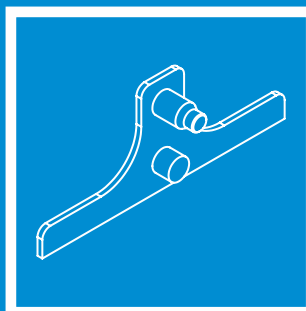

side base EF

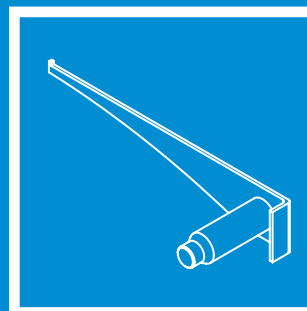

left shelf holder

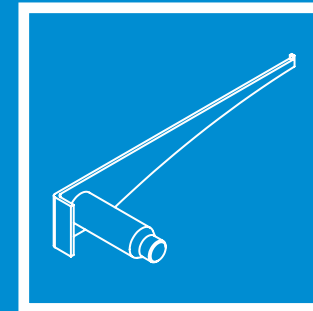

right shelf holder

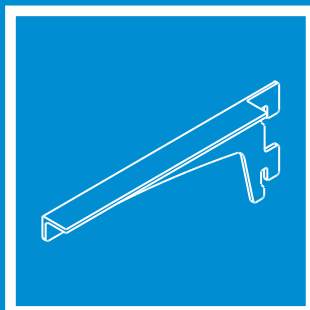

left shelf support
(for H profile)

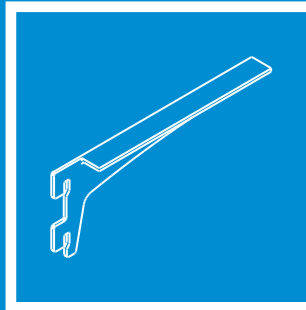

right shelf support
(for H profile)

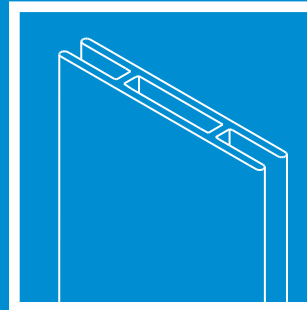

H profile
(for shelf support)

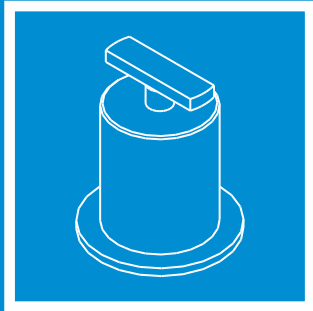

**Connector
door - profile 38'**

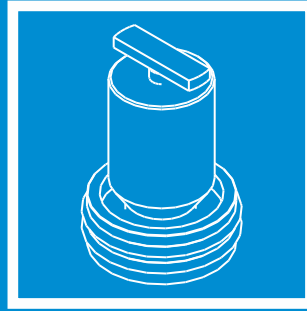

**Connector 1/2
frame - profile 46'**

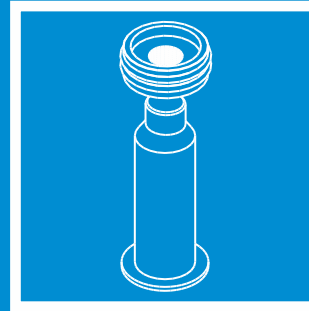

**Connector
door - frame 84'**

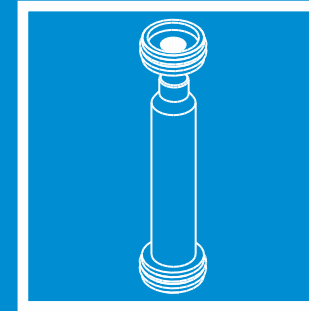

**Connector
door - hinge 135'**

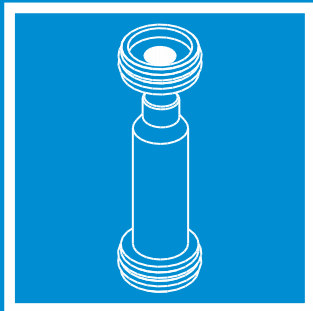

**Connector
frame - frame 103'**

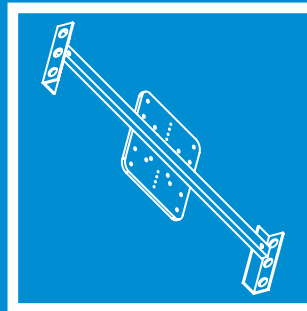

LCD/TV mount

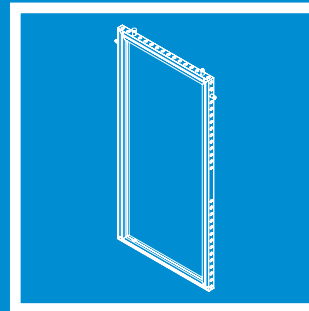

EF Door

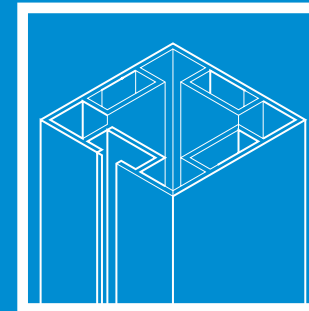

**one-sided
corner profile**

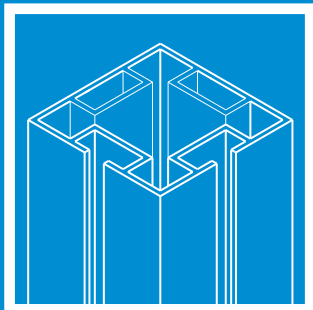

**two-sided
corner profile**

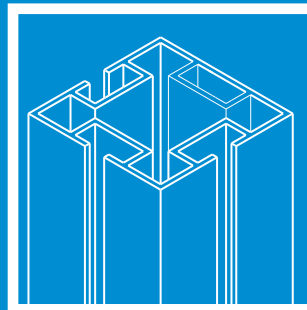

**three-sided
corner profile**

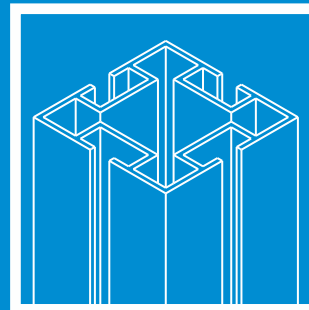

**four-sided
corner profile**

EASY FRAMES 80

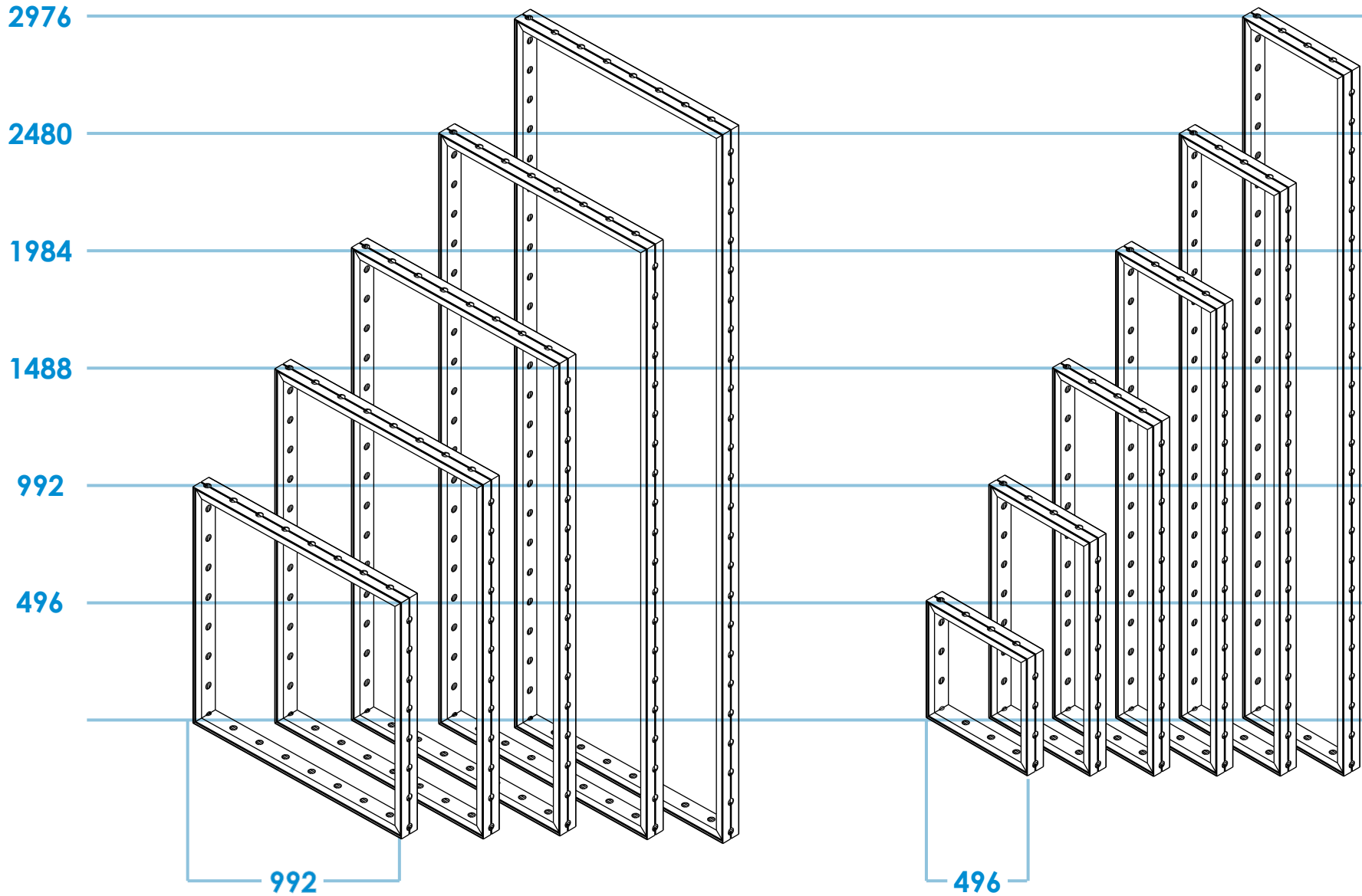

EASY FRAMES 80

The double-sided profiles with holes around created for strong aluminum modular frames especially for the exhibition industry. The family product of Eltex 55 EF. This one is 80 mm thick and matches also both fabric and panel (PVC, dibond) on both sides of the profiles. A wide range of accessories for customers' comfort available.

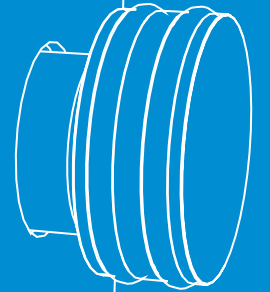
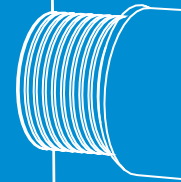

AKCESORIA EZ80

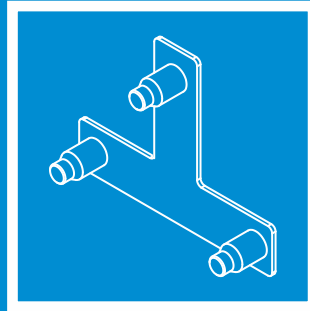

T - plate

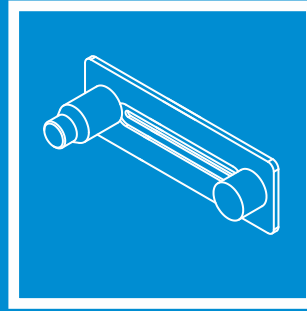

lamp holder

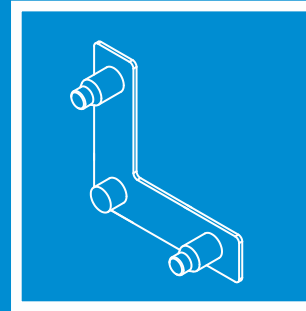

left corner plate

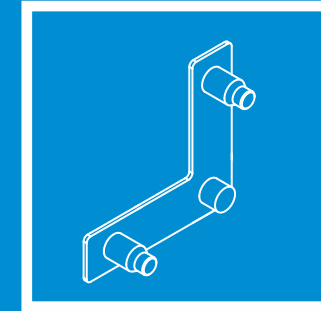

right corner plate

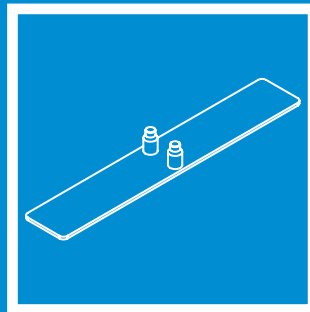

base EF 600x100

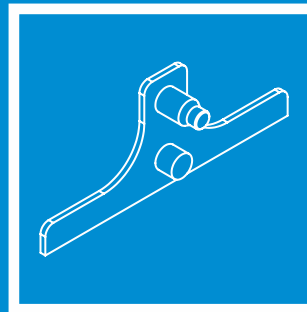

side base EF

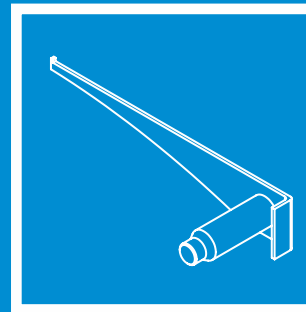

left shelf holder

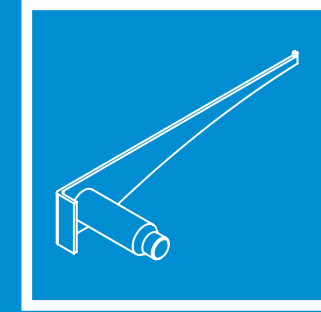

right shelf holder

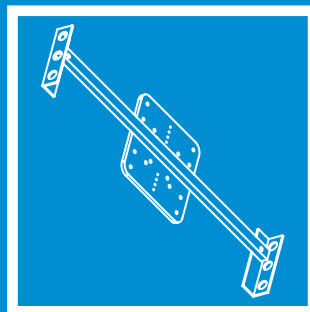

LCD/TV mount

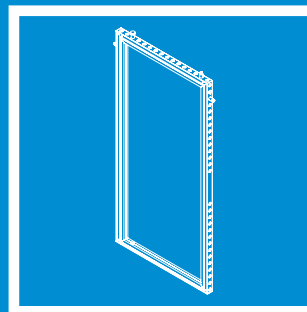

EF door

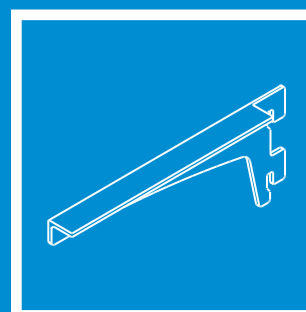

left shelf support
(for H profile)

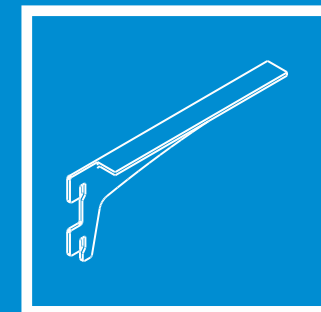

right shelf support
(for H profile)

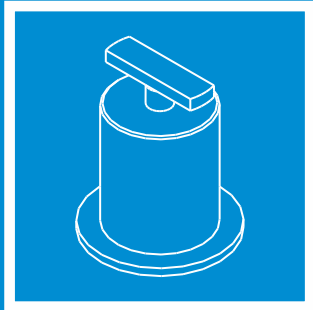

**Connector
door - profile 38'**

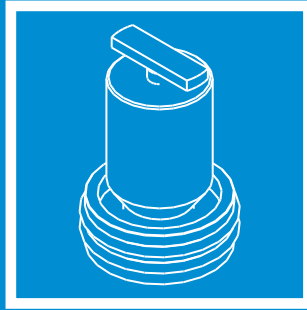

**Connector 1/2
frame - profile 46'**

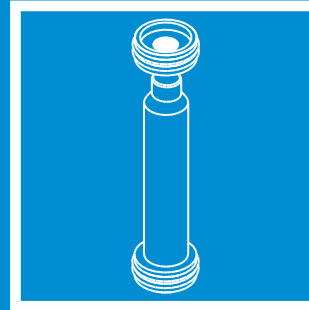

**Connector
door - hinge 135'**

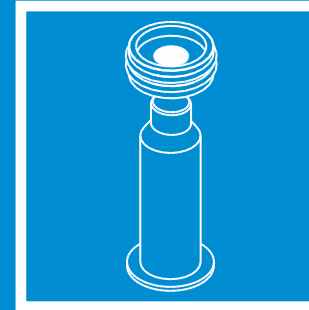

**Connector
door - frame 84'**

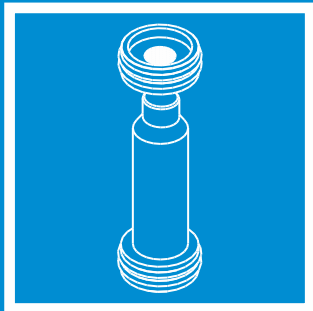

**Connector
frame - frame 103'**

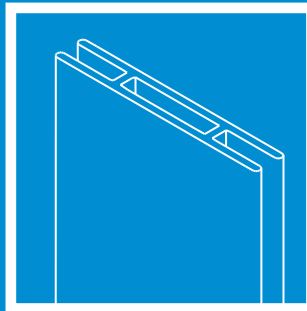

**H profile
(for shelf support)**

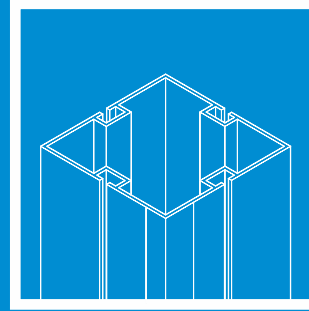

MX 80

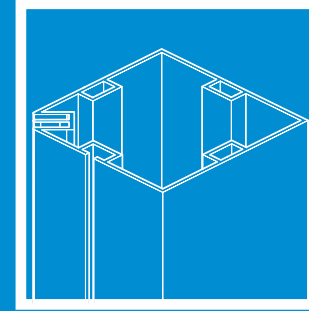

**MX 80 edge
one-sided**

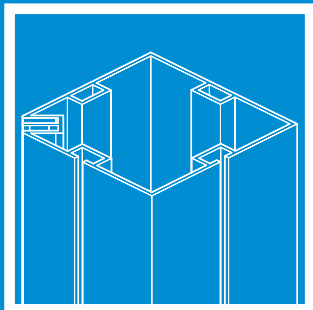

**MX 80 edge
two-sided**

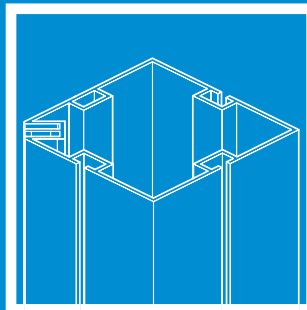

**MX 80 edge
three-sided**

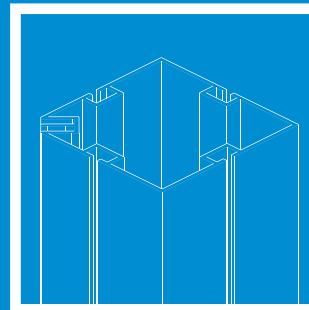

**MX 80 edge
four-sided**

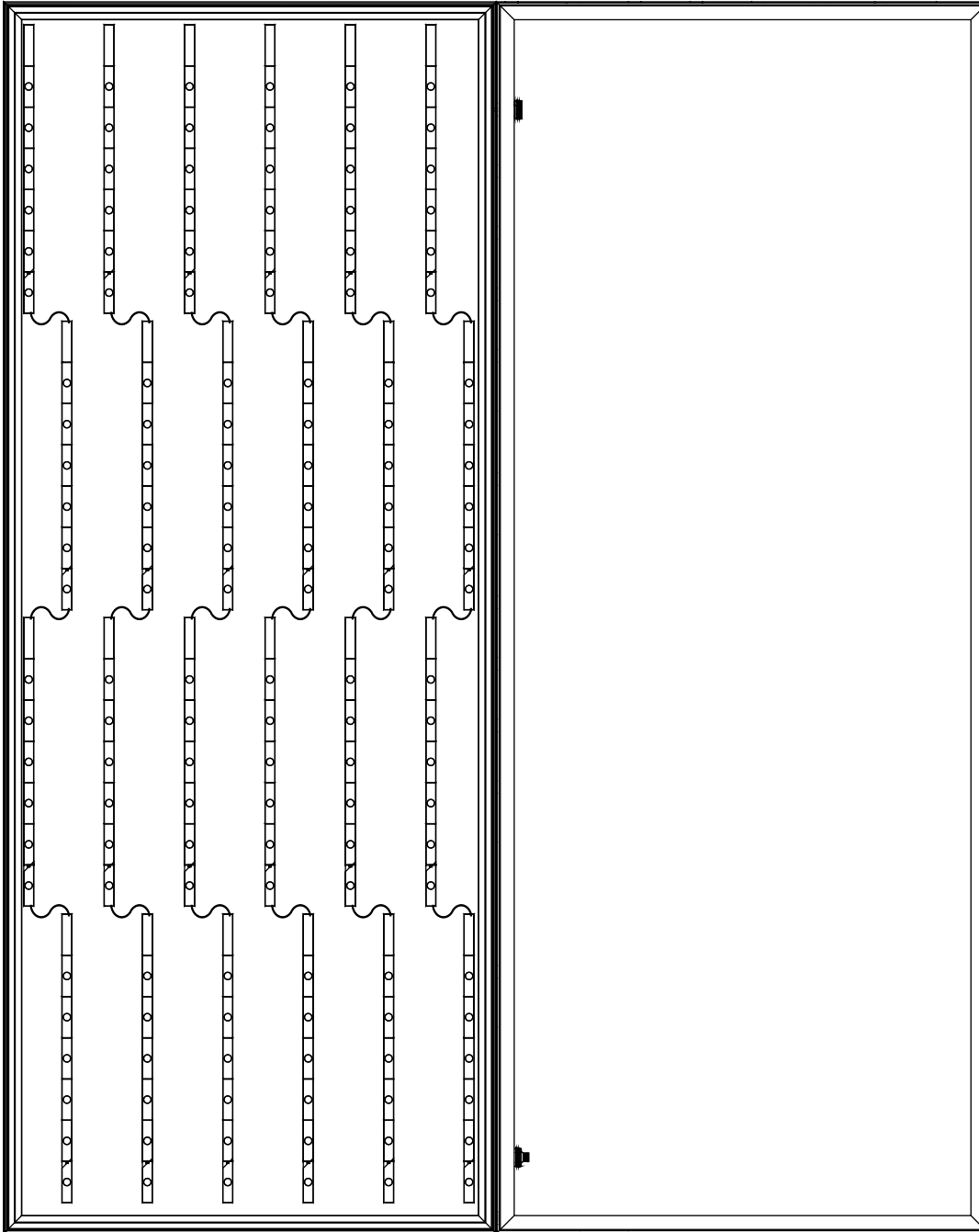

LIGHTBOX S80

This single-sided profile can be successfully used while creating exhibition and store spaces.

Moreover, the profile is compatible with our MX System and Easy Frames, that is why the booth built on the basis of the both systems is uniquely modern.

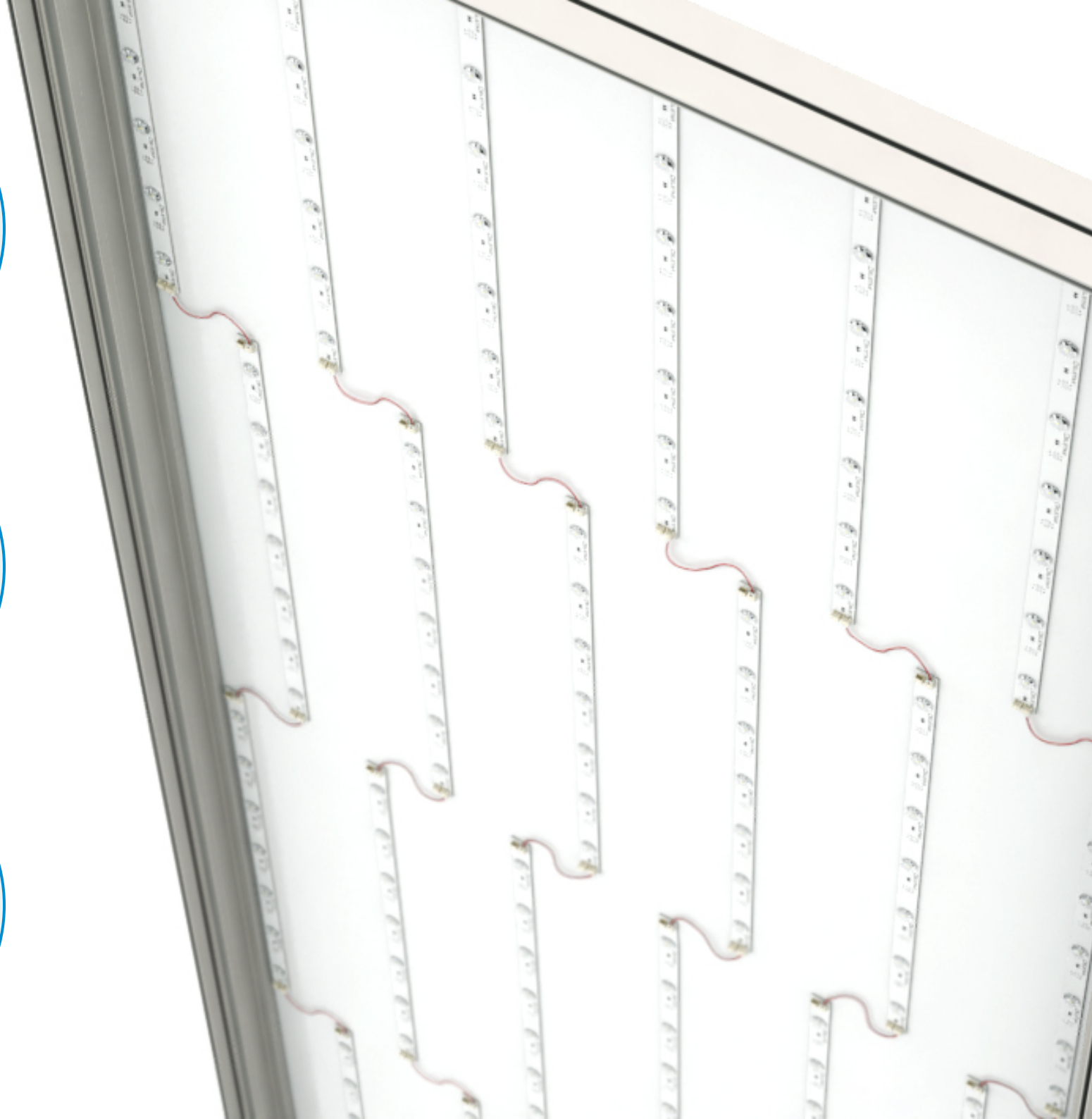

HOW IT WORKS



D



E



E



Fill it with graphic

You can use variety of materials:

- Fabric
- PVC sheet
- Aluminum composite panel (dibond)





EZ FRAMES 55
992x2480 FRAME

LAMP HOLDER

SHELF SUPPORT
for H profile

CORNER PROFILE
two-sided

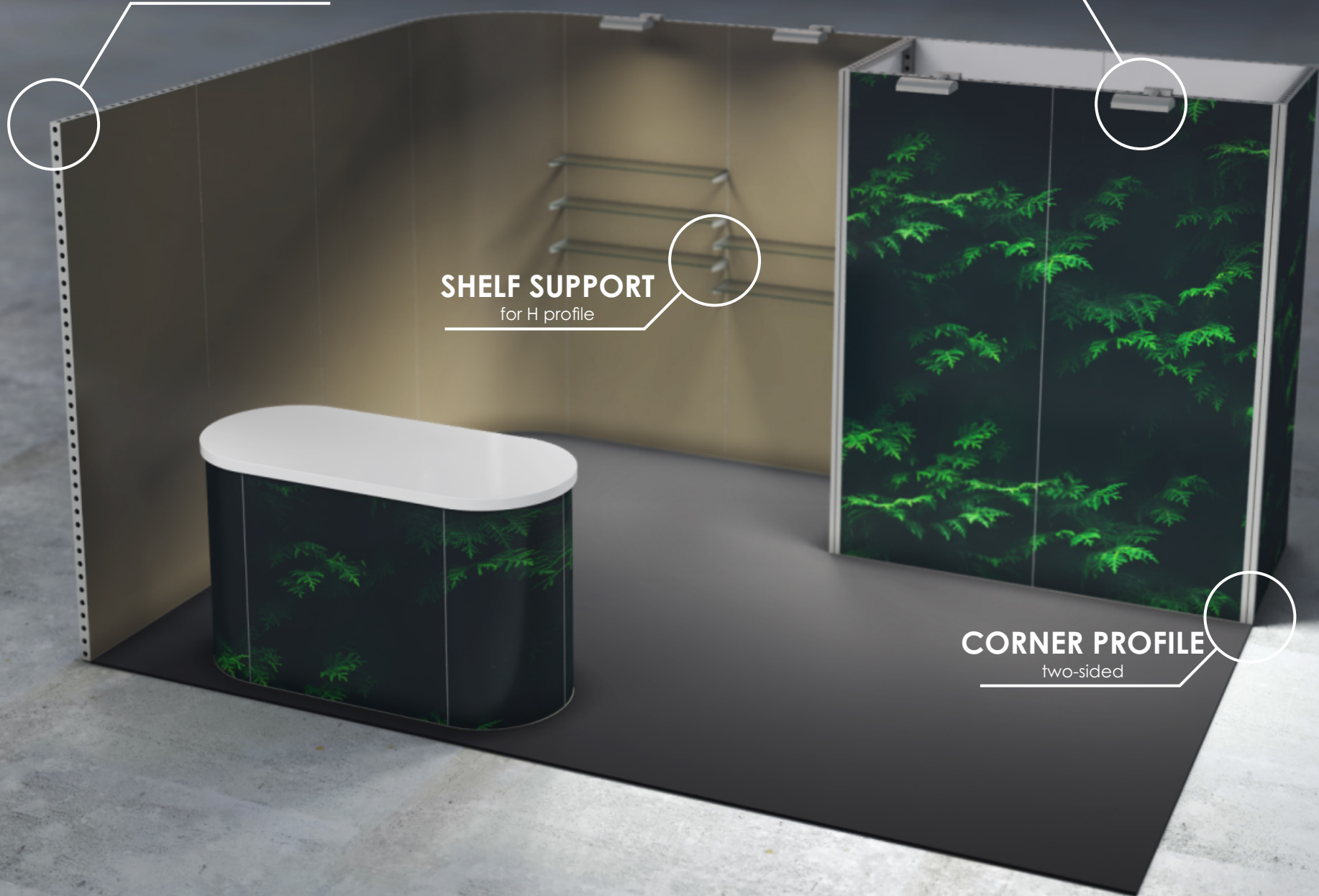

EZ FRAMES 80
992x2480 FRAME

MX80

TV/LCD MOUNT

LAMP HOLDER

EF DOOR



ul. Skórzewska 32
62-081 Wysogotowo
Poland

Tel: +48 61 826 82 93

Tel: +48 61 826 83 18

Email: info@elstarsystem.com

www: www.elstarsystem.com